

Basic Setup of Sennheiser EW 100 G4 Series Wireless Systems

In most cases the wireless systems frequency will already have been set before you left the store. Follow these steps to turn the system on.

1. Plug ac into back of the receiver and attach antennas. Connect cable from the output on the rear of the receiver to your mixer (ensure volume on mixer is down to start). Press the power button briefly to turn on the receiver (largest button on far right of front face of receiver).
2. Open battery compartment on transmitter. For the handheld unit simply unscrew the bottom section of the mic. Insert batteries (2xAA) and replace cover. Locate on the base of the handheld unit is the **On/Off** button, a small red button, press briefly. For a body pack unit press in the latches on either side of the battery cover. Insert batteries (2xAA) and briefly press the **On/Off** button to turn on.
3. The displayed frequency should match on both the transmitter and receiver. The frequency number will be six digits in this format 000.000. Begin speaking into the mic and the AF indicator on both displays should activate. The mic is now ready to use. Slowly bring up the volume on your mixer

Synchronizing a Transmitter with a Receiver

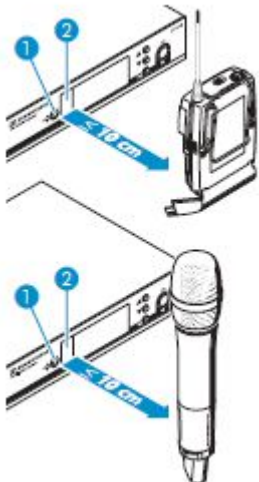

To transfer the currently displayed frequency of the Receiver to the transmitter;

1. Make sure the transmitter and receiver are both on
2. Press the **Sync** button on the receiver. "SYNC" appears on the display panel of the receiver.
3. Place the infra-red interface of the transmitter in front of the infra-red interface of the receiver (on belt packs the infra-red sensor is located under the battery cover). The parameters are automatically transferred. When the transfer is complete a check mark appears on the display panel. The receiver then switches back to the standard display

To have the receiver scan for a clear frequency follow these steps.

1. Follow first 2 steps at top of page.
2. Briefly press **SET** on receiver to access menus. Using the arrow up and down keys on face of receiver search for **Easy Setup**. Briefly press **SET**.
3. Using arrow up and down keys look for **Scan New List**. Briefly press **Set**. The receiver will scan for open frequencies and create a bank listing the available frequencies, press **Set**. You are now at the first available frequency. Press **Set** to store. Use arrow up and down keys to find **Exit**. Press **Set**. Search for **Exit** again and press **Set**. Sync this frequency with transmitter (see above section)
4. For multiple systems repeat these 3 steps one system at a time

EM 100

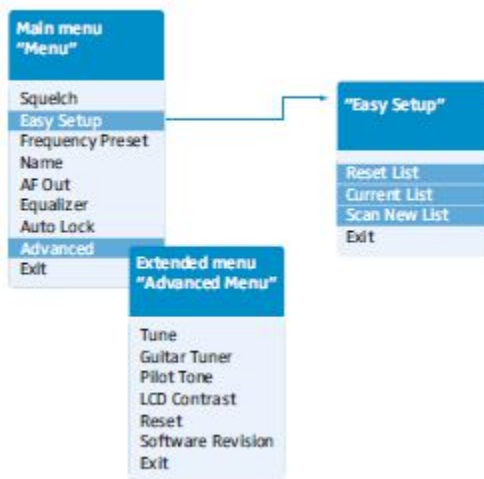

Turning off Power

1. Press and hold **ON/OFF** button until unit shuts off.